



## Standard Ground Mounting System

Enerack ground mounting systems suitable for installation system of medium or large scale ground power station. Each Components are Maximize pre-assembled, widely save your labor cost and install time

Customized allowed according to project wind & snow load, provide economic & effective solutions .

The designed with ground screw result in fast, easy and cost efficient installation.

### Product Overview

Install Site: Outdoor flat ground, Mountain, Terraced field.

Material: AL6005-T5, Q235, SUS304

Standard: AS/NZ1170.2, JIS C 8955, MCS 012, TUV, UL2703 etc.

Tilt Angle: 5°~60°

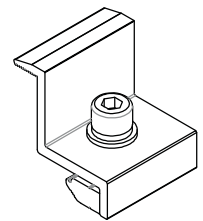
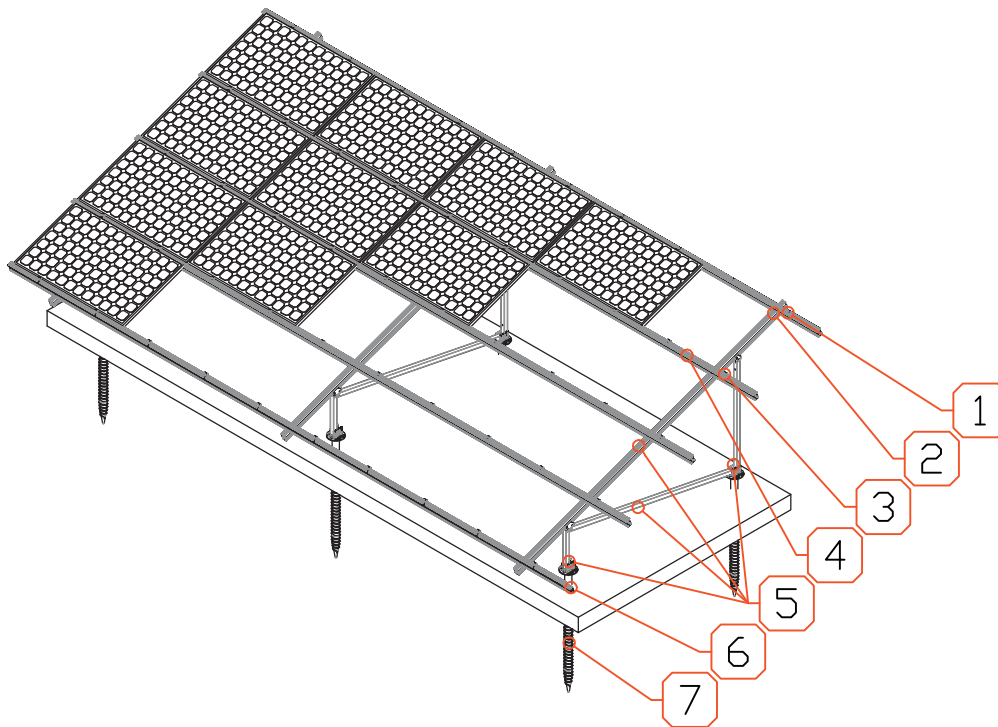

1. End clamp

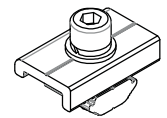

2. Rail clamp

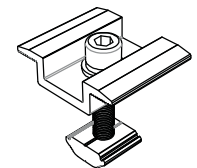

3. Inner clamp

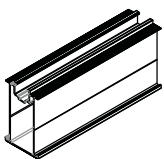

4. Rail

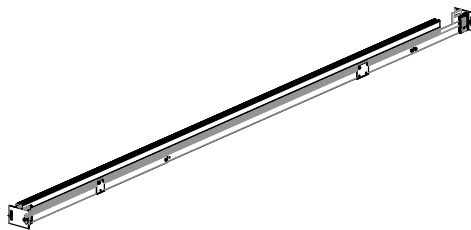

5. Pre-assembled support

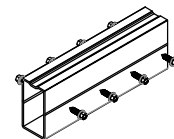

6. Rail connect

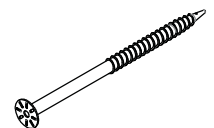

7. Ground screw